

RESIDENTIAL PROPERTY RECORD CARD

Date Printed 12/13/16

Owner Information

Parcel 08-01-11001  
 Owner SENTINEL PINE ORCHARDS, INC  
 PO BOX 268  
 SHOREHAM, VT 05770-0268  
 Location 832 WITHERELL RD  
 Descr: 524.87 A & ORCHARD, PACKING HOUSE & DWLG

Parcel Information

Tax Map # 08-01-11.001 NBHD 10  
 Span 591-186-00224 Acres 524.87  
 Status A - Active Last Update 04/12/16  
 Sales Information  
 Book Sale Date 1 / 1  
 Page Sale Price 0

Parcel Value Information

Land Value 771,200 Homestead 895,900  
 Dwelling Value 203,000 HouseSite 361,000  
 Site Imprvmt 40,000  
 Outbuildings 567,100  
 Misc. Adj. 0  
 Total 1,581,300

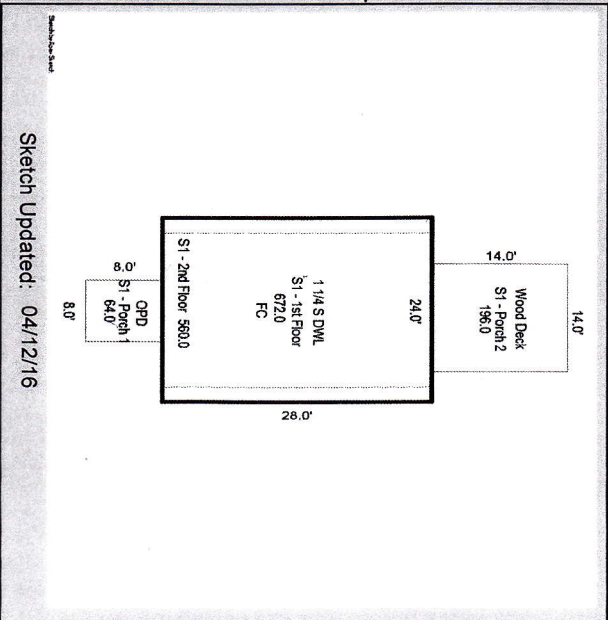

BUILDING

Total Rooms	5	Year Built	1991	Building SF	1260	Energy Adj	Good	Roughins	1
Bedrooms	3	Effect Age	15.0	Quality	3.00	Bsmt Wall	Conc 8"	Plumb Fixt	8
Full Baths	2	Condition	Average	Style	1.5 Fin	Bsmt SF	672.00	Fireplaces	0
Half Baths	0	Phys Depr	14	Design	CapeCod	Bsmt Fin	UnFinish	Porch	196
Kitchens	1	Funct Depr	0	Bldg Type	Single	Bsmt Fin SF	0	Gar/Shed	0
		Econ Depr	0				% Complete:		0

LAND	CALC	Fmnt&Dpth	LAND	Bldg Lot	AREA	GRADE	FRONTAGE
		Acreage	Other		522.87	1.00	250.00
						1.00	0.00

NOTES